

Section S2

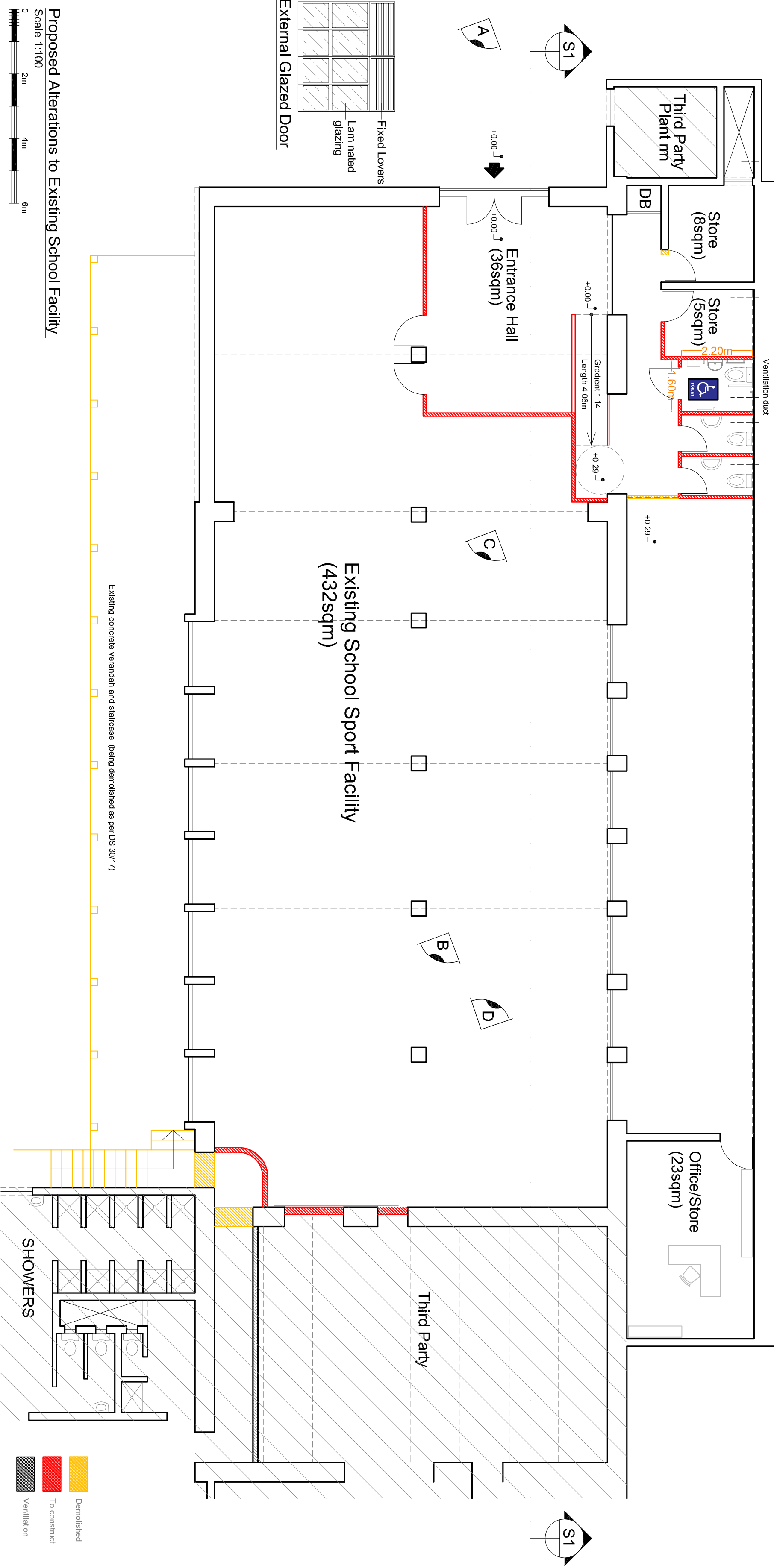

Proposed Alterations to Existing School Facility
Scale 1:100

Specialist: Tas-Serra Hannan		Project Title: School Sport Facility		Drawing: Proposed Plan		Date: 25/09/17	
Unless otherwise specified Dimensions are in mm		SIZE: A3 NET-03-16		REVISION: R2		Remarks: External apertures in white aluminium and laminated glass Steel shutter for the main door Facade fair faced and potted	
Tolerances: DO NOT SCALE DRAWING		Scale: 1:100 Sheet: 1 of 2		Designer: Mario Bonaldi A&CE			